



Gerber Architekten



## 2nd Training Centre for the Federal Revenue Administration

The building wing for education, accommodation and sports is designed with brick walls, that are typical for the regional building types. The fan-shaped building volume is built around a court, that is a central element for communication. It is open towards the cafeteria. On the streetside, the building volume is rather closed, which gives the building an urban character. The living wing of the building corresponds to the surrounding landscape.

<https://www.gerberarchitekten.de/en/project/2nd-training-centre-for-the-federal-revenue-administration/>





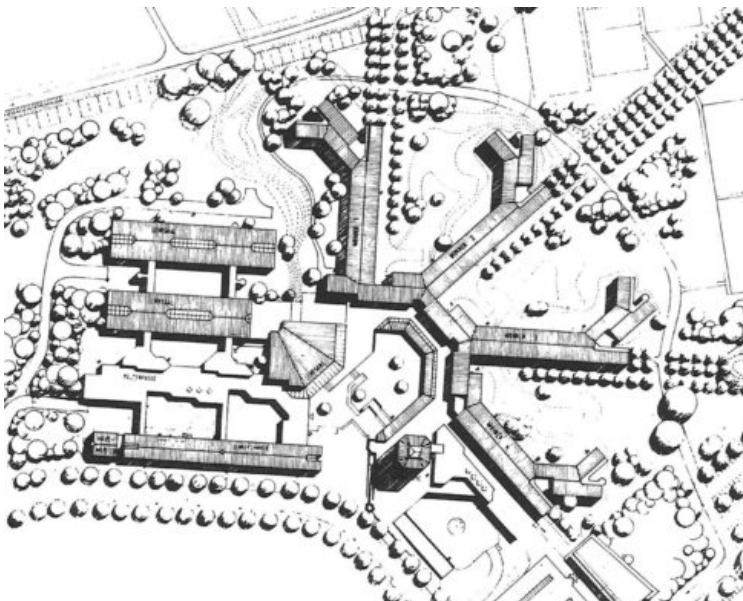



Gerber Architekten

Dortmund  
Hamburg  
Berlin  
Riad  
Shanghai

[www.gerberarchitekten.de](http://www.gerberarchitekten.de)

**Bildnachweis · Picture Credits**

Für individuelle Foto-/Bild-Nachweise wenden Sie sich bitte an:  
*For individual photo credits please contact:*

Gerber Architekten  
Tönnishof 9-13  
44149 Dortmund  
Germany  
Fon: +49 231 9065 - 0  
Fax: +49 231 9065 - 111  
E-Mail: [kontakt@gerberarchitekten.de](mailto:kontakt@gerberarchitekten.de)