



Gerber Architekten



## Biological Institutes of Dresden University of Technology

In landscaped terraces, topography and vegetation continue as an optical and spatial link in the outdoor temperature hall and give the new institute building an open atmosphere. From the southern entrance at the level of the first floor, a path leads across the terraces to the ground floor, which is at the level of the main entrance in the north. Curved steel stringers border the planted terraces, in which steps and seats made of Bangkirai are embedded. The glass hall acts as a climate buffer for the rooms facing it, which has a positive effect on energy saving. The vegetation runs through the hall like a green carpet and leads to a fusion of architecture and landscape.

> Landscape Architecture

<https://www.gerberarchitekten.de/en/project/institutes-for-biological-research-dresden-university/>

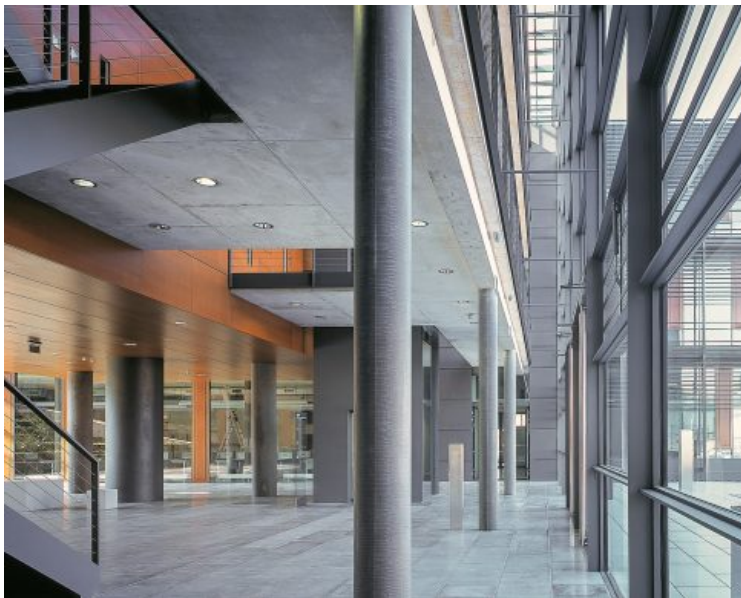







Gerber Architekten

Dortmund  
Hamburg  
Berlin  
Riad  
Shanghai

[www.gerberarchitekten.de](http://www.gerberarchitekten.de)

**Bildnachweis · Picture Credits**

Für individuelle Foto-/Bild-Nachweise wenden Sie sich bitte an:  
*For individual photo credits please contact:*

Gerber Architekten  
Tönnishof 9-13  
44149 Dortmund  
Germany  
Fon: +49 231 9065 - 0  
Fax: +49 231 9065 - 111  
E-Mail: [kontakt@gerberarchitekten.de](mailto:kontakt@gerberarchitekten.de)