



Gerber Architekten



## Residential Development Petrivierteil

The design of two new buildings completes the neighbourhood development of the 'Petrivierteil' near the historic old town of Rostock. The five-storey buildings form the end of the living rows with reference to the water and allow intergenerational living. On the street side, a closed appearance ensures maximum privacy. Balconies and loggias on the courtyard side expand the living space and create a link to the landscape. Conservatories as protruding cubes structure the façade in such a way that protected recreation areas are created despite the open construction method. The projections and cantilevers characterise the modern character of the façade and at the same time open up the apartments to the landscape with their direct location on the water.

<https://www.gerberarchitekten.de/en/project/residential-development-petrivierteil/>



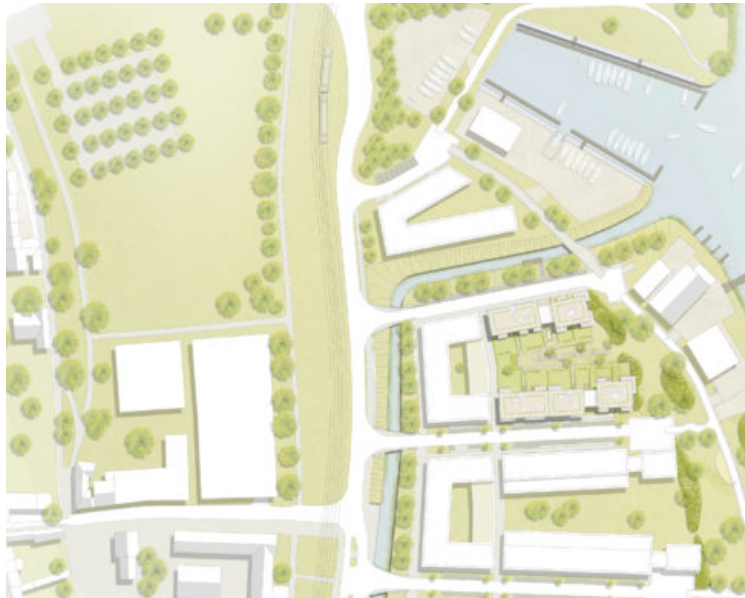



Gerber Architekten

Dortmund  
Hamburg  
Berlin  
Riad  
Shanghai

[www.gerberarchitekten.de](http://www.gerberarchitekten.de)

**Bildnachweis · Picture Credits**

Für individuelle Foto-/Bild-Nachweise wenden Sie sich bitte an:  
*For individual photo credits please contact:*

Gerber Architekten  
Tönnishof 9-13  
44149 Dortmund  
Germany  
Fon: +49 231 9065 - 0  
Fax: +49 231 9065 - 111  
E-Mail: [kontakt@gerberarchitekten.de](mailto:kontakt@gerberarchitekten.de)